

ROCKER SWITCHES

Miniature rocker on/off single pole single throw. 10 Amp, 250V AC, solder lugs 17.4mm x 13mm 2.5mm panel



Part Number
RSM1

Miniature rocker on/off double pole single throw. 10 Amp, 250V AC, spade/solder lugs 17.4mm x 13mm



Part Number
RSM3

Miniature rocker on/off/on single pole double throw. 6 Amp, 250V AC, spade/solder lugs 17.4mm x 13mm 2.5mm panel



Part Number
RSM6

Miniature rocker with LED on/off single pole single throw. 6 Amp, 250V AC, solder lugs 17.4mm x 13mm 2.5mm panel



Part Number
RSM7

Miniature rocker with neon light on/off double pole single throw. 10 Amp, 250V AC, solder lugs 17.4mm x 13mm 2.5mm panel



Part Number
RSM9

ILLUMINATED

Computer rocker on/off double pole double throw, grey. 10 Amp, 250V AC, solder lugs 22.9mm x 25.2mm 3.5mm panel



Part Number
CRS10

DPDT PADDLE SWITCH

Contact rating - 2A @ 250V AC
Electrical life - 50,000 cycles
Contact resistance - <10m Ω ?
Insulation resistance - >1000m Ω ?
Dielectric strength - >1000V 1 minute



Part Number
S1250

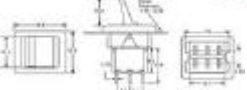

DPDT MINI ROCKER SWITCH

Contact rating - 2A @ 250V AC
Electrical life - 50,000 cycles
Contact resistance - <10m Ω ?
Insulation resistance - >1000m Ω ?
Dielectric strength - >1000V 1 minute



Part Number
S1270

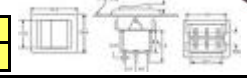

PANEL MOUNT ROCKER SWITCHES

Switch type - DPDT Alternate
Contact rating - 3A @ 250V AC
Panel Cutout - 12mm?
Panel Thickness - 6mm Max



Part Number	Type
S3180	Red Rectangular

Switch type - SPST Alternate
Indicator - Red LED
Contact rating - 6A @ 250V AC
Panel Cutout - 20mm?
Panel Thickness - 6mm Max



Part Number	Type
S3190	Round with LED
S3191	Without LED

ILLUMINATED

Switch type - SPST Alternate
Indicator - Red LED
Contact rating - 6A @ 250V AC
Panel Cutout - 20mm?
Panel Thickness - 6mm Max

ILLUMINATED



Part Number	Type
S3192	Paddle with LED

Switch type - SPST Alternate
Contact rating - 6A @ 250V AC
Panel Cutout - 20.2mm?
Panel Thickness - 3mm Max



Part Number	Type
S3188	Black Round

MINI ROCKER

Contact rating - 6A @ 250V AC
Panel cutout - 19 x 13mm
Electrical life - 10,000 cycles
Mechanical life - 15,000 cycles
Contact resistance - <20m Ω ?
Insulation resistance - >1000m Ω ?
Dielectric strength - >1500V 1 minute >3000V between poles



Part Number	Type
S3210	SPST
S3212	DPST
S3215	SPDT

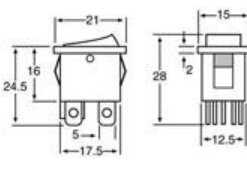

MINI ROCKER - ILLUMINATED

Neon colour - Red or Green
Neon Voltage - 240V AC

ILLUMINATED



Part Number	Colour
S3216	Green
S3217	Red

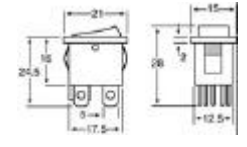

MINI ROCKER WITH LED

Switch type - SPST
Contact rating - 6A @ 250V AC
LED colour - Red
LED voltage - 1.8V DC
Panel cutout - 19 x 13mm
Electrical life - 10,000 cycles
Mechanical life - 15,000 cycles
Contact resistance - <20m Ω ?
Insulation resistance - >1000m Ω ?
Dielectric strength - >1500V 1 minute >3000V between poles



Part Number
S3220

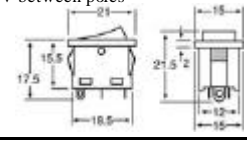

SLIMLINE ROCKER SWITCH

Switch type - SPST
Contact rating - 6A @ 250V AC
Panel cutout - 19.2 x 6.8mm
Electrical life - 10,000 cycles
Mechanical life - 50,000 cycles
Contact resistance - <20m Ω ?
Insulation resistance - >1000m Ω ?
Dielectric strength - >1500V 1 minute



Part Number
S3202

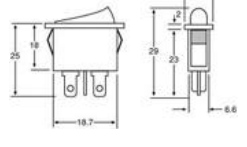

WHITE ILLUMINATED ROCKER

Switch type - SPDT
Contact rating - 10A @ 250V AC
Neon Colour - Red
Neon voltage - 240V AC
Panel cutout - 30 x 11mm
Electrical life - 10,000 cycles
Mechanical life - 30,000 cycles
Contact resistance - <20m Ω ?
Insulation resistance - >1000m Ω ?
Dielectric strength - >2000V 1 minute



ILLUMINATED

Part Number
S3230

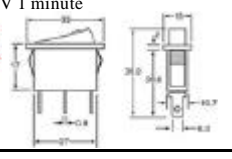

HEAVY DUTY ROCKER

Switch type - DPDT
Contact rating - 15A @ 250V AC
Neon Colour (S3242) - Red
Neon voltage (S3242) - 240V AC
Panel cutout - 30 x 22mm
Electrical life - 50,000 cycles
Mechanical life - 20,000 cycles
Contact resistance - <50m Ω ?
Insulation resistance - >1000m Ω ?
Dielectric strength - >1500V 1 minute >3000V between poles

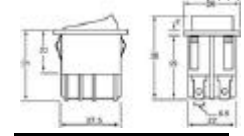

Part Number	Colour
S3242	Red
S3245	Black

ILLUMINATED

HEAVY DUTY ILLUMINATED ROCKER

Switch type - DPDT
Contact rating - 10A @ 250V AC
Neon Colour - Red
Neon voltage - 240V AC
Panel cutout - 27 x 22mm
Electrical life - 20,000 cycles
Mechanical life - 100,000 cycles
Contact resistance - <20m Ω ?
Insulation resistance - >50m Ω ?
Dielectric strength - >3500V 1 min.



Part Number
S3240

ILLUMINATED

Switch type - DPDT
Contact rating - 10A @ 240V AC
Neon Colour - Red
Illumination - 12V lamp
Overall size - 23 x 30.5 x 33mm
Clearance - 30mm
Panel cutout - 27 x 22mm
Mounting - Snap lock

Part Number
P7708

ILLUMINATED

Switch type - SPST
Contact rating - 10A @ 250V AC
Neon Colour - Red
Neon voltage - 240V AC
Panel cutout - 27.6 x 13.8mm
Electrical life - 20,000 cycles
Mechanical life - 100,000 cycles
Contact resistance - <50m Ω ?
Insulation resistance - >100m Ω ?
Dielectric strength - >1500V 1 minute



ILLUMINATED

Part Number
S3228

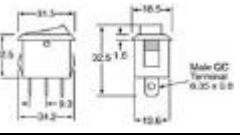

Switch type - SPST
Contact rating - 10A @ 250V AC
LED - Red, 1.8V DC
Panel cutout - 27.6 x 13.8mm
Electrical life - 20,000 cycles
Mechanical life - 100,000 cycles
Contact resistance - <50m Ω ?
Insulation resistance - >100m Ω ?
Dielectric strength - >1500V 1 minute



ILLUMINATED

Part Number
S3226

